

Comfy Snug Plush Music & Vibration Bouncer

Instruction manual

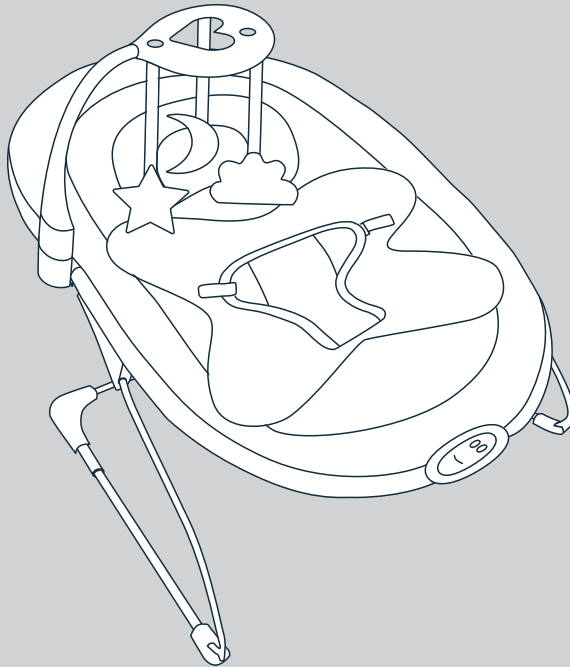

**IMPORTANT - RETAIN FOR FUTURE
REFERENCE. READ CAREFULLY.**

Warning: A child's safety is your responsibility.

This product is tested to EN 12790-1:2023

1. Contents

- 1. Contents01
- 2. Welcome02
- 3. Safety instructions03
- 4. Battery safety instructions03
- 5. Parts list04
- 6. Assembly05-10
- 7. Safety harness11
- 8. Vibrations/Music box11
- 9. Care and maintenance12
 - 9.1. Cleaning12
 - 9.2. Maintenance12

2 .Welcome

Thank you for purchasing the Puggle Comfy Snug Plush Music & Vibration Bouncer.

Please read the instructions and warnings carefully before use to ensure safe and satisfactory operation of your Puggle Comfy Snug Plush Music & Vibration Bouncer.

If you have a query with this product or require replacement parts, please contact Online4baby online at online4baby.com/contact-us.

3. Safety Instructions

IMPORTANT! PLEASE READ THE FOLLOWING INSTRUCTIONS CAREFULLY BEFORE USING THE PRODUCT.

- **WARNING!** Read these instructions carefully before assembly and use and keep for future reference. The child may be hurt if you do not follow these instructions.
- **WARNING!** This product is suitable for one child from birth (up to max. weight 9kg). **Do not use the bouncer once the child starts trying to sit up.**
- **WARNING!** Follow the manufacturer's instructions.
- **WARNING!** Prevent serious injury or death.
- **WARNING! Never leave the child unattended.**
- **WARNING! ALWAYS use the restraint system ensuring it is correctly adjusted at all times.**
- **WARNING! This reclined cradle is not intended for prolonged periods of sleeping.**
- **WARNING!** NEVER use for a child that is able to sit up unassisted.
- **WARNING!** Do not attempt to move or lift the product when a child is in it.
- **WARNING! FALL HAZARD:** Child's activity may move product. Use only on the floor. Never use on an elevated surface.
- **WARNING! SUFFOCATION HAZARD:** Never use on a soft surface (bed, sofa, cushion), as seat may tip over and cause suffocation.
- **WARNING!** Never use this product on an elevated surface (e.g. a table).
- **WARNING!** The toy bar is not a handle. **Never use the toy bar to lift or carry the product.**
- Never leave baby in the bouncer without supervision.
- Do not use the bouncer once the child can sit up unaided.
- Baby's movements could make the bouncer tip over.
- Do not use the bouncer if any part is broken or missing.
- Always use the restraint system, ensuring it is correctly adjusted at all times.
- Before using, check that all parts are properly locked into position and adjusted correctly.
- Check the suspension system of the bouncer regularly.
- Only use a 3-point safety harness.
- Do not use the bouncer without its seat liner.
- **WARNING!** Do not use this product on an elevated surface i.e. a table. Place on stable, dry, level floor only.
- Never place the bouncer on a soft surface (bed, sofa, cushion), as seat may tip over and be dangerous for baby.
- This reclined cradle does not replace a cot or cot bed. Should your child need to sleep, then it should be placed in a suitable cot or cot bed.
- This reclined cradle is not intended for prolonged periods of sleeping.
- The bouncer is not a carrycot, nor a car seat. Always use the straps and adjust them properly, even if baby will only be in the bouncer for a short time.
- Do not use near an open fire or any other kind of heater.
- Keep the plastic bags of the packaging out of reach of babies and young children to avoid any risk of suffocation.
- Never add any pillow, blanket or padding to the bouncer.
- Do not put objects with strings around the neck of your baby, do not hang strings from the bouncer and do not attach strings to toys. This could lead to strangling.
- Do not put the bouncer close to a window where the strings of a blind or curtains could lead to strangling.

3. Safety Instructions

- Do not allow your baby to play with the bouncer folded up.
- Do not attach other toys than those supplied.
- **WARNING!** NEVER place a child under 2.26kg (5 lbs) or over 9kg (20 lbs) in the product.
- Discontinue use of product should it malfunction or become damaged.
- Do not use this product if any components are broken or missing.
- **WARNING!** Stop using the product when the child starts trying to sit up.
- Only use authorised additional replacement parts. Do not use accessories or replacement parts other than those approved by the manufacturer.
- Keep children away from the product during assembly and when not in use.
- Do not let other children play unattended near the product.
- Adult assembly required.
- This bouncer conforms to EN 12790-1:2023

4. Battery Safety Instructions

Use a small cross head screwdriver to open the battery compartment door on the vibration/music box (E). Insert the battery as indicated inside the battery door and replace the screw. The vibration/music box requires 2 "AA" Alkaline batteries.

ATTENTION! BATTERY SAFETY: KEEP FOR FUTURE REFERENCE.

WARNING! Dispose of used batteries immediately. Keep new and used batteries away from children. If you think batteries might have been swallowed or placed inside any part of the body, seek immediate medical attention.

CAUTION: To prevent possible battery leakage, be sure to follow the guidelines outlined below:

- Insert batteries in the correct polarity position (+ and -).
- Do not short circuit battery terminals.
- Remove batteries during long periods of non-use. Always remove exhausted batteries from product. Dispose batteries properly.
- Use caution when opening battery compartment as some batteries may leak, explode or catch on fire.
- Do not submerge in water or other liquids.
- Do not dispose of this product in a fire. The batteries inside may explode or leak.
- Only batteries of the same or equivalent type as recommended are to be used.
- Do not charge non-rechargeable batteries.
- Different types of batteries or new and used batteries are not to be mixed.

The vibration/music box requires 2 "AA" Alkaline batteries (not included).



The symbol on the product or its packaging indicates that this product must not be disposed of with your other household waste. Instead, it is your responsibility to dispose of your waste equipment by taking it to a designated collection point for the recycling of waste electrical and electronic equipment.

The separate collection and recycling of your waste equipment at the time of disposal will help conserve natural resources and ensure that it is recycled in a manner that protects human health and the environment. Please contact your local authority for more information about where you can drop off your waste for recycling.

5. Parts List

A



B



C

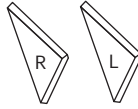

D



E

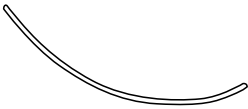

F

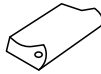

G

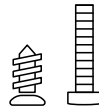

H

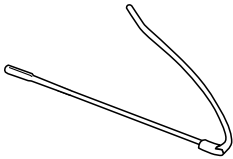

I

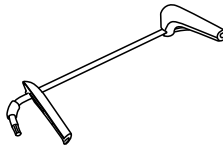

J

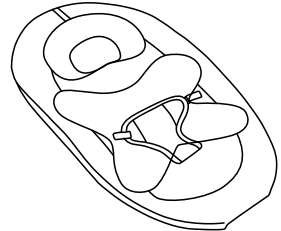

K

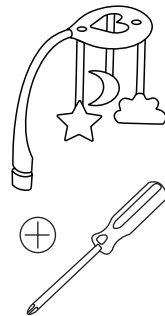

Contained in your carton are:

Nº	Part	Qty
A	Seat back frame	2
B	Seat back connector	1
C	Plastic connector	2
D	Vibration box (batteries not included)	1
E	Footrest frame	2
F	Footrest frame connector	1
G	Screws	6
H	Support frame	2
I	Rear connector tube	1
J	Seat pad	1
K	Toy bar (with 3 x toys)	1

*Toys may vary slightly from illustration

*cross head screwdriver not included

6. Assembly

Check that all parts are present before starting assembly.

6.1. On a flat surface, place the left (H) and right (H) support frames opposite each other, with the rear connector tube (I) between them.

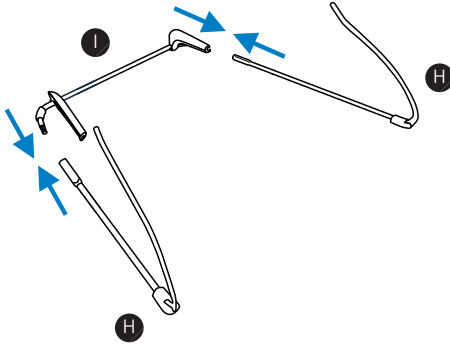

6.2. Lift the flip clip on both sides of the rear connector tube and lift the left support frame and right support frame into the rear frame tube. Close the flip clip over the tube and press down until the flip clips lock in place.

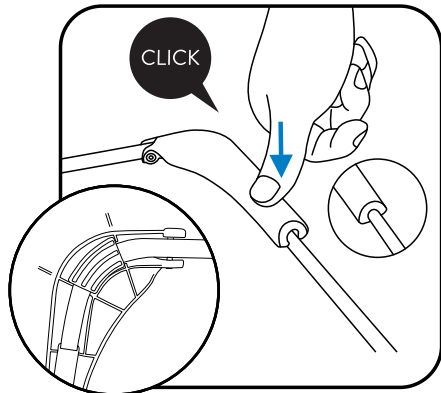
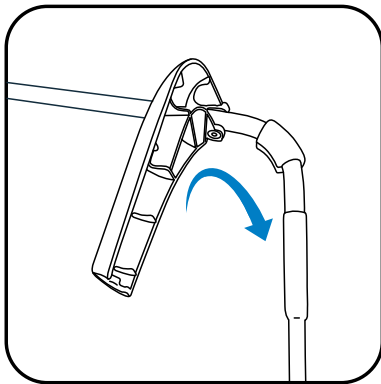

6. Assembly

6.3. Fit left plastic connector (C) to the left support frame with the holes facing inwards and secure with screw (G). Repeat process to fit the right plastic connector (C) to the right support frame.

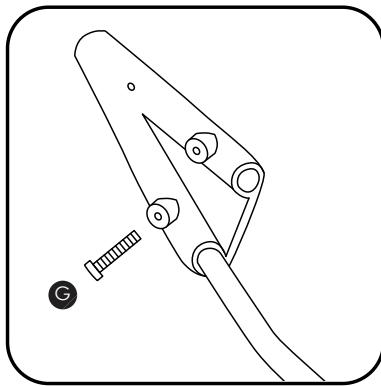
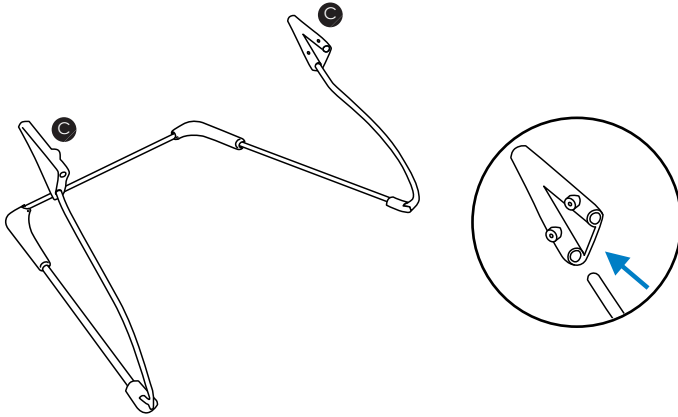

6. Assembly

6.4. Fit both ends of the seat back frame (A) into the allocated holes in the seat back connector (B). Once connected fit both ends of the seat back frame (A) into the plastic connectors (C). Push the frame until the pin locks into the allocated holes.

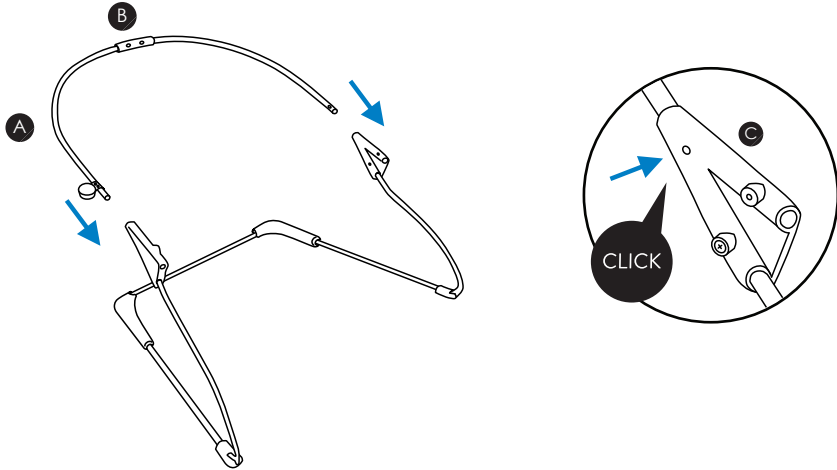

6.5. Fit both ends of the footrest frame (E) into the footrest frame connector (F). Once connected fit both ends of footrest frame (E) into the plastic connectors (C) and secure with screws (G).

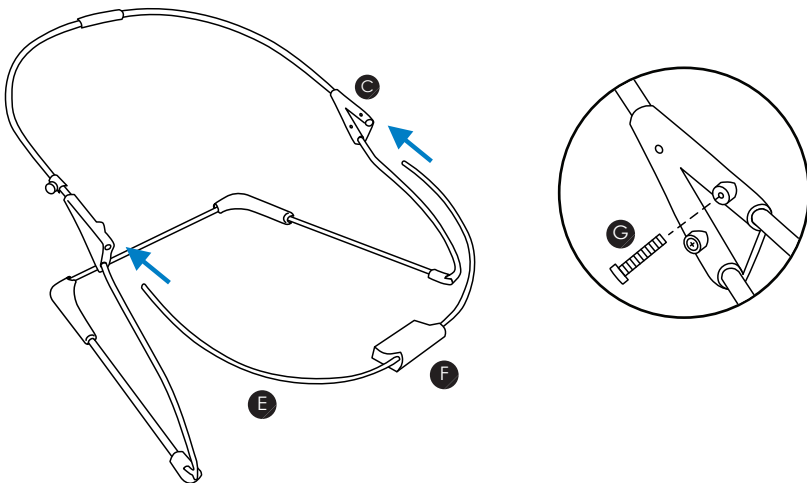

6. Assembly

6.6. Undo the clips on the back of the seat pad (J) and open the pocket at the rear.

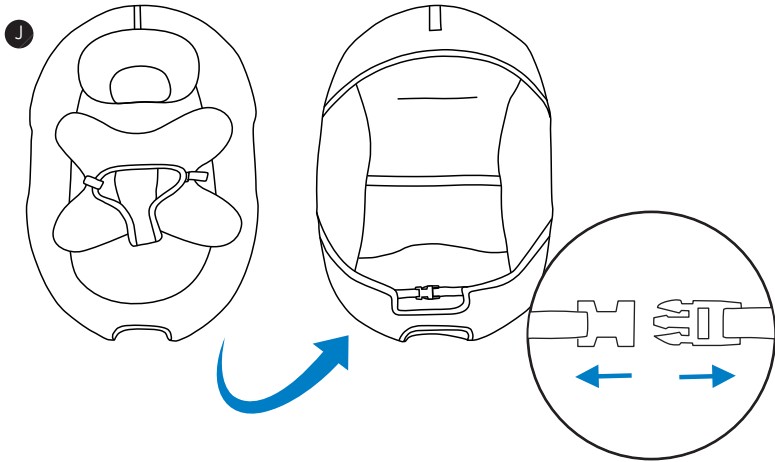

6.7. Slide the seat pad (J) over the backrest frame and stretch the bottom of the seat pad over the footrest frame.

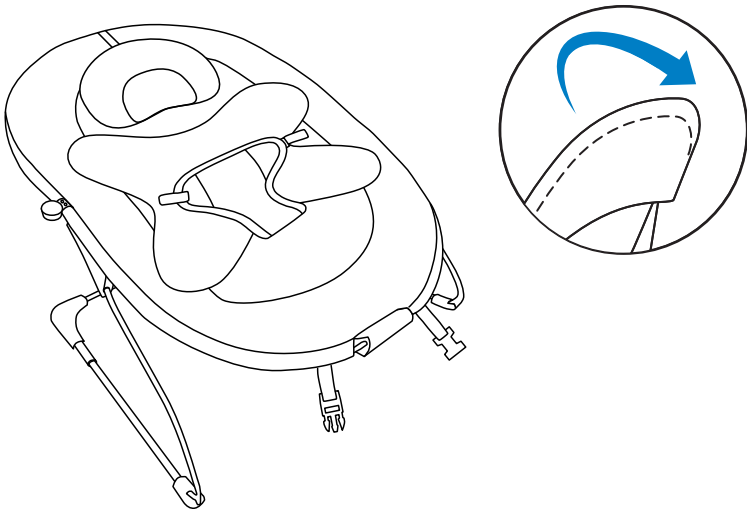

6. Assembly

6.8. Slide the top of the vibration box (D) through the hole in the seat pad and onto the footrest frame. Fasten the clips under the seat. Reverse this process to remove the vibration box.
NOTE. Ensure the vibration box has been fixed the right way up.

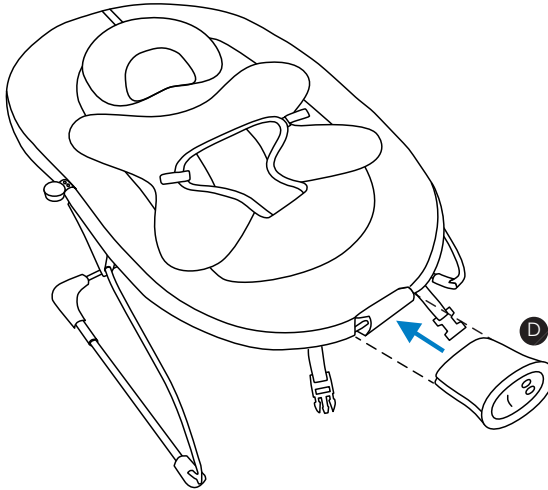

Fasten the clips under the seat. Reverse this process to remove the vibration box.
NOTE. Ensure the vibration box has been fixed the right way up.

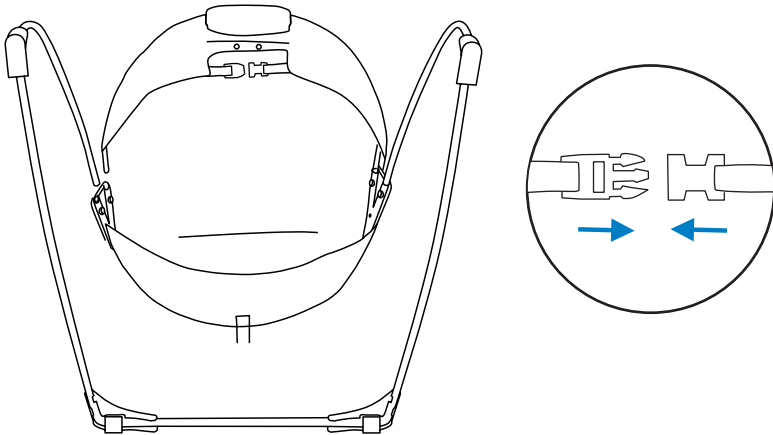

6. Assembly

6.9. Clip the toy bar and toys (K) to the side of the bouncer frame. Pull the lip to remove the toy bar just above the plastic connector.

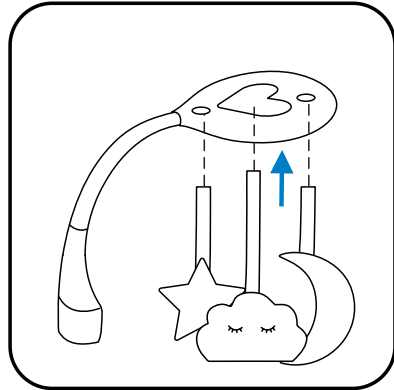
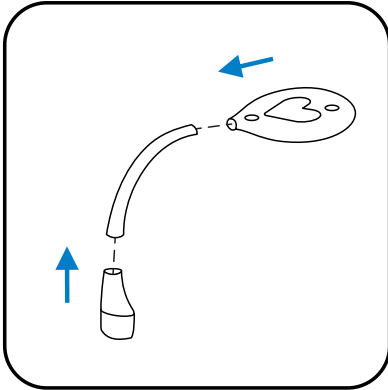

WARNING!

The toy bar is **NOT** a handle.
Never attempt to carry the
reclined cradle by the toy bar.

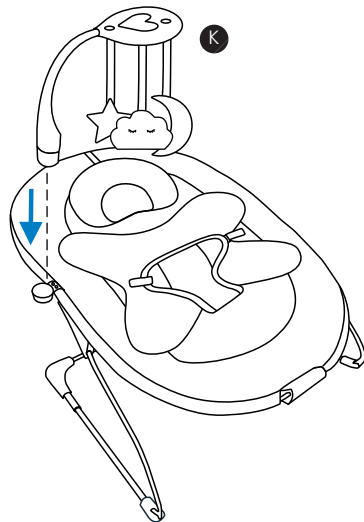
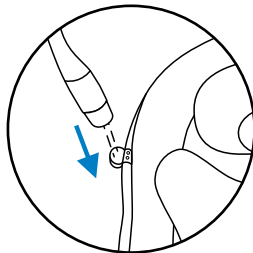

7. Safety Harness

7.1. Place baby in the bouncer with the crotch strap positioned between their legs. Fasten the buckles on both sides of the restraint. A “click” will signal buckle is secure. Adjust the sliders on both straps to achieve a snug, comfortable fit. To release, press the clips on the buckles and remove the harness strap.



WARNING!

ALWAYS use the restraint system.

Attaching:

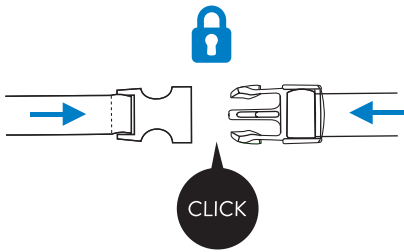

Removing:

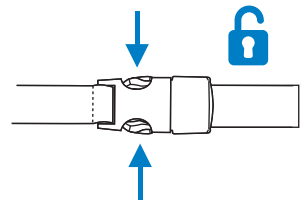

8. Vibration/Music Box

8.1. The vibration/music box has 3 vibration speeds. Press the vibration button to start vibration. Continue pressing the button to increase the vibration speed. When on the fastest vibration, press the button again to turn off the vibration. There are 8 melodies with 3 volumes. Press the music button to start the melody. Press the button a second and third time to increase the volume. Pressing the button another time will move to a new melody. The melody will automatically stop.

Vibration:



Music:



9. Care and Maintenance

9.1. CLEANING

- The fabric cover is removable for easier cleaning.
- Do not wash the fabric cover. Spot clean only using soft sponge with diluted detergent or water. Do not rub. Dry in shade.
- Do not iron.
- Do not dry clean.
- Do not wash the toys. Wipe clean only using a soft sponge with diluted detergent or water. Do not rub.
- Clean metal or plastic components with mild detergent and warm water.
- Never use abrasive, ammonia based, bleach based or spirit type cleaners.
- Ensure the product is fully dry before use or storage.

9.2. MAINTENANCE

- All assembly fittings are to be tightened properly.
- Inspect regularly and re-tighten as necessary.
- Store product in a dry location away from any heat sources, and not in the sun.
- Do not use accessories or replacement parts other than those approved by the manufacturer.



If you have any questions or concerns regarding this product,
do not hesitate to contact our expert team online
via online4baby.com/contact-us

Feeling social?  
online4baby.com

Imported by Online4baby Ltd,
Meadowbank, Tweedale Way, Oldham, OL9 8EH, UK